

Report of the Ad-Hoc Committee on Space

L. Billera (Chair), C. Earle, P. Kahn

May, 2003

Abstract

There are benefits to the department and the university in having the option of retiring as an emeritus professor remain attractive. To achieve this, the department should strive to provide appropriate facilities for those emeritus professors who wish to remain active professionally. Since space for emeritus professors competes with other uses of this increasingly scarce resource, the department needs to plan ahead and to consider its priorities. We shall make some comments about this in the body of this report.

1 Goals and objectives for emeritus offices:

At the very least, there should be attractive, well-equipped, and secure pool space available on an as-needed basis. This should include computer equipment as well as space to store a limited amount of books and papers.

The more ambitious goal of shared offices (two people per office) for most emeritus professors is preferable, if possible.

In any case, there should be the possibility to assign on a short-term basis more private space (small single offices) to those currently active in research or teaching. (All office assignments should be reviewed periodically, perhaps yearly, or, in case of teaching, by the term.)

As the number of active emeritus professors is likely to increase in the next few years, meeting these goals will place new demands on our already scarce space.

2 The current situation:

At this point, nearly five years since the Mathematics Department moved into Malott Hall, we have begun to experience a shortage of available space for both offices and potential expansion of computational research facilities. This has been brought on, among other reasons, by

1. a slight increase in the number of graduate students and postdocs caused by the VIGRE Grant, as well as
2. an increase in the number of emeritus professors.

In addition, but less pressing, there has been

3. an increase in the number of graduate students from other institutions working with incoming and part-time faculty.

The numbers caused by (1) are likely steady for the near term (although they will be slightly lower next year due to the budgetary hiatus in the VIGRE grant. Those caused by (3) will depend on the amount of future senior hiring, so it is unsure which way these will go. Those caused by (2), however, will only increase for the foreseeable future.

In addition, initiatives such as an expanded research computing laboratory environment are essentially impossible given the absence of suitable space. It is also generally felt that the lack of use of the undergraduate computer facility (in Stimson Hall) is due, in large part, to our inability to house it in Malott.

Given the current departmental priorities for assigning space, there does not seem to be any room to expand in the space currently allotted to the department in Malott. There is some concern on the committee that the space allocated to the Department of Statistical Sciences in Malott is being used mostly to provide second offices for statistics faculty from ILR and OR. However, short of intervention from well beyond the department, this is not likely to change in our favor.

3 The alternatives:

We are therefore left with the problem of reallocating the existing space in light of these increased demands for it. In particular, space for the increasing

number of emeritus professors must be viewed as competing with demands from other than the permanent teaching and administrative staff. These include (in no particular order)

- Non-teaching visitors
- Teaching visitors
- Lecturers/computer staff
- Graduate student lounge
- Kitchen¹
- Math Support Center.

It seems clear that allocating private offices to the first three groups, and maintaining the current space allocation for the last three uses, could come at the cost of decreasing ability to hire new faculty as people choose to defer retirement. It could also decrease participation in the life of the department by those who do retire.

We feel that if active emeritus professors are made to share offices, then so should the first group, and thought should be given to sharing among those in the second and third group that are essentially part-time. Further, it should be noted that the grad lounge is equal in space to a small faculty office, the kitchen¹ to about 1.5 faculty offices and the Math Support Center occupies the equivalent of 4 faculty offices (currently one quarter of this space is serving as storage for discarded computer equipment).

As for locating a pool office in the current space, the office on the third floor now occupied by the computer systems administrator would seem to be an attractive, if not large, choice. There is a large conference room in the library (420C) that does not seem to be much used, but this is not in the space allocated to the department, and the fact that it is inside the library makes access problematic at best. However, some creative shuffling of space may be possible: for example, the library conference room could replace the current conference room, which in turn might be used as a "pool office" for emeritus faculty.

¹This is the official name for the room commonly referred to as the *Staff Lounge*.

4 A recommendation:

As we do not see how to solve the problem of space allocation for emeritus professors without considering the allocation of space to the above-mentioned groups, we conclude with the following statement:

Departmental space is almost on a par with permanent lines as a basic departmental resource, and it plays an important role in the recruitment of faculty and graduate students and in the viability of numerous department activities. Accordingly, the overall management of departmental space and space-policy requires active, ongoing faculty leadership, whether by the chair or by a designated senior faculty member or faculty committee.

5 Appendix

The following figures give the current allocation of department space according to the type of usage:

- regular faculty
- postdocs (VIGRE, HC Wang and NSF)
- teaching visitors
- non-teaching visitors
- lecturers
- emeritus professors
- staff offices
- lounges
- Math Support Center
- TA consulting/grading
- Statistical Science offices.

There are two copies of each floor plan. The numbers in each room on the first copy denote the floor area in square feet. The second is color-coded to indicate type of use during the 2003-2004 academic year.

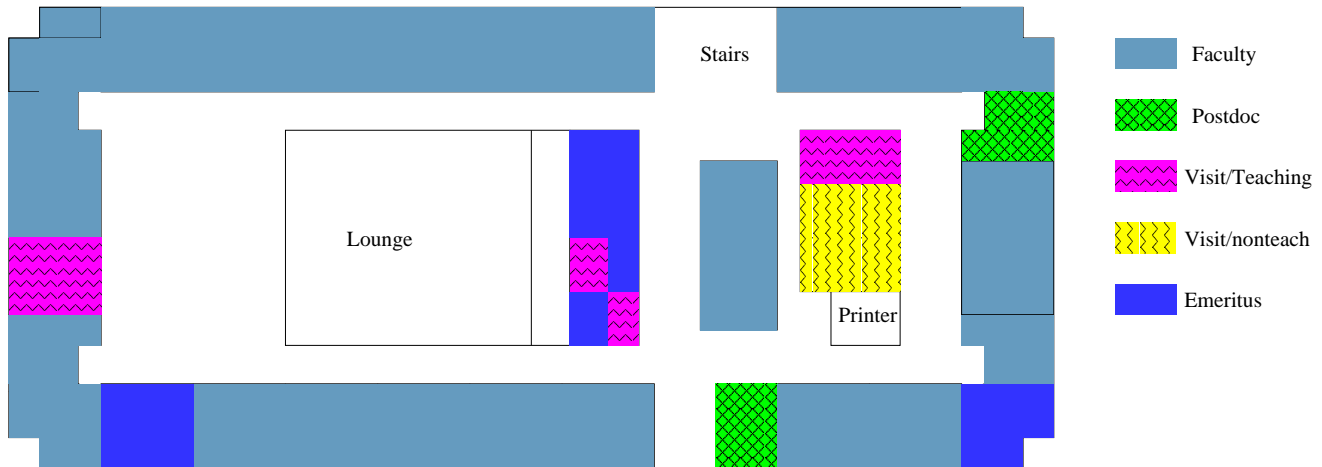
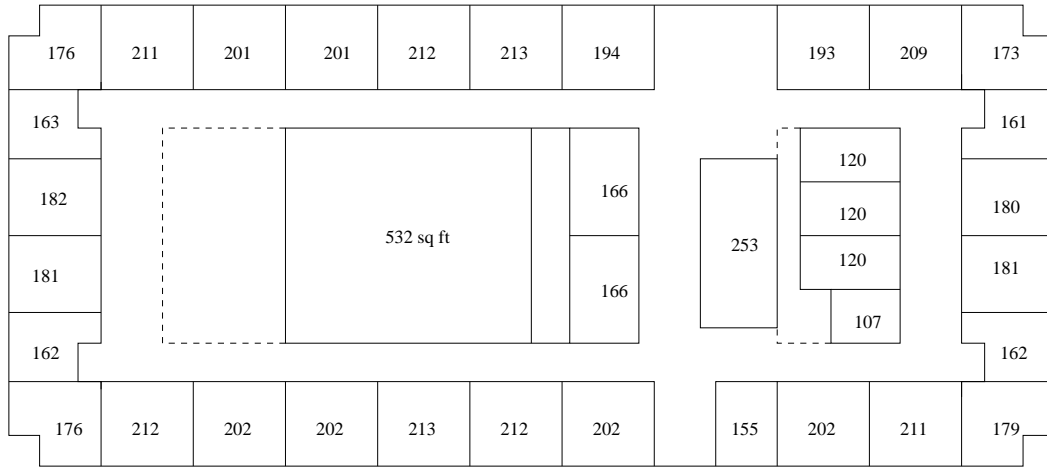

Fifth floor - Main building

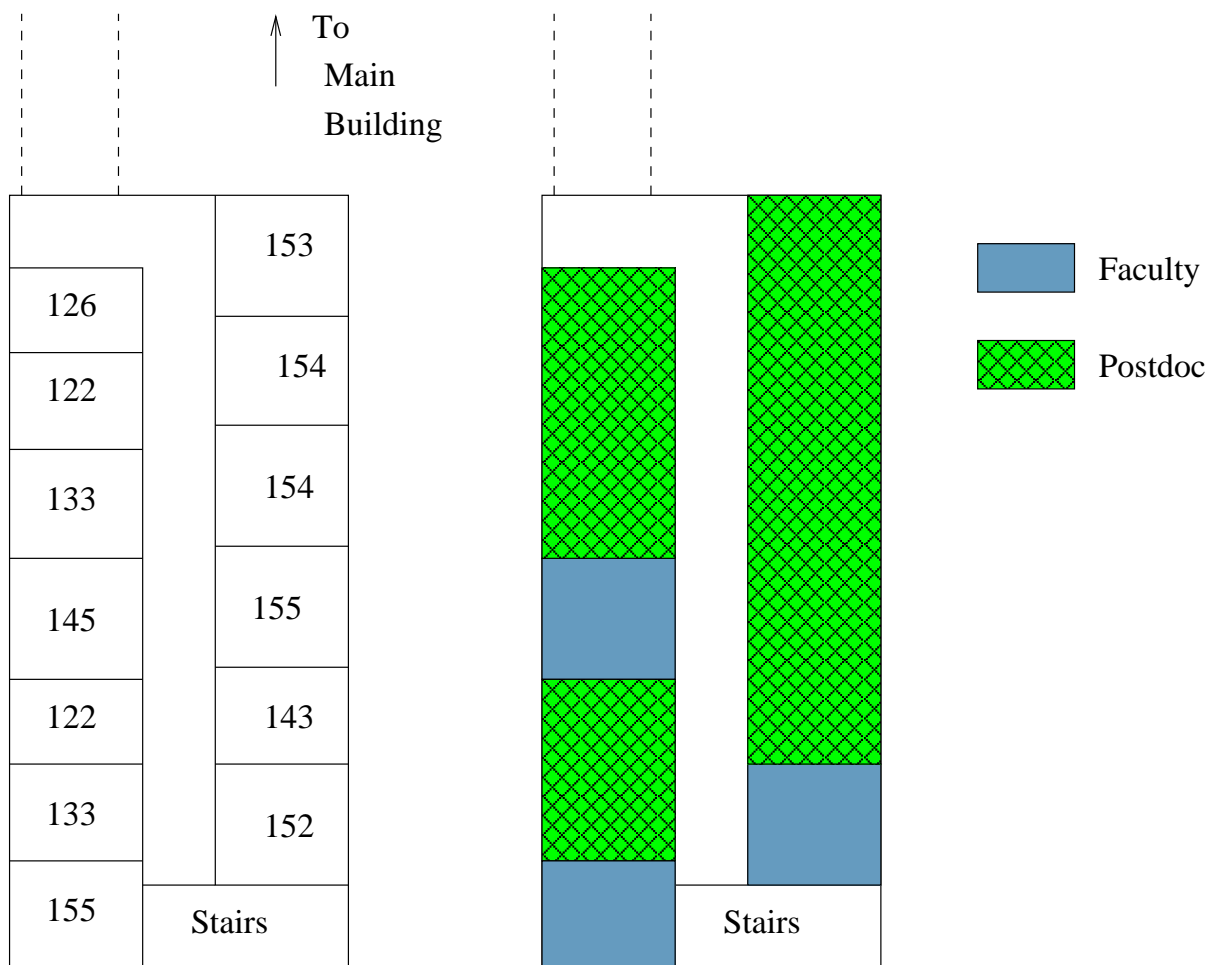

Fifth floor - Annex

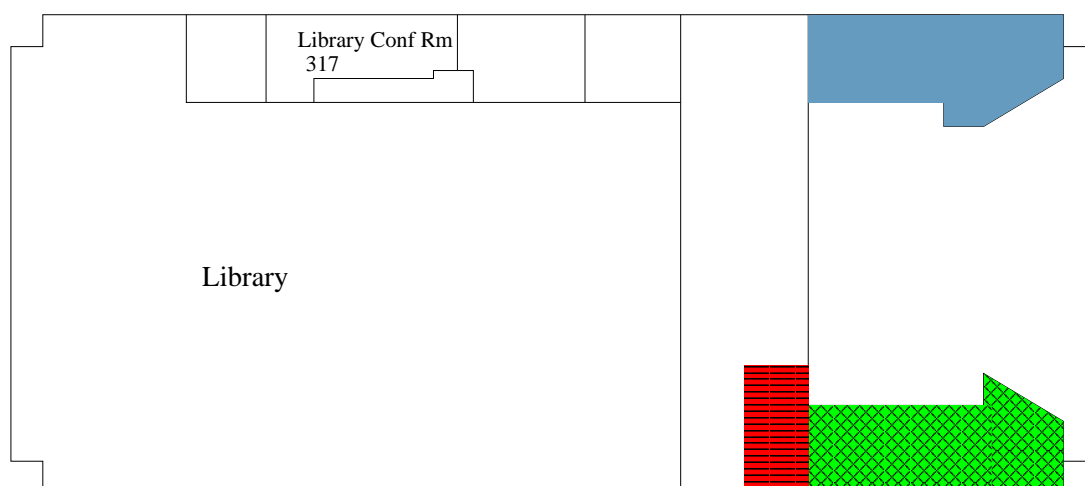
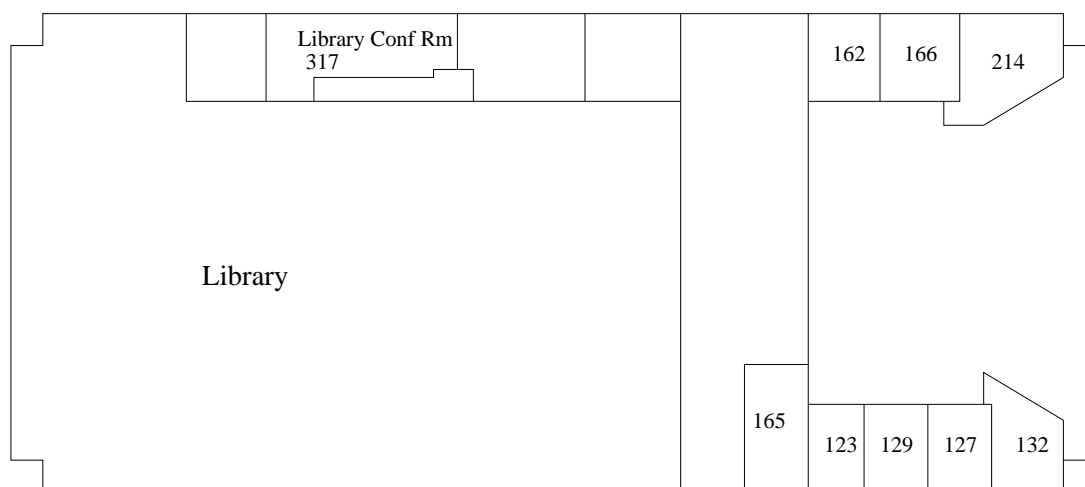

- Faculty
- Postdoc
- Lounge

Fourth floor - Main building

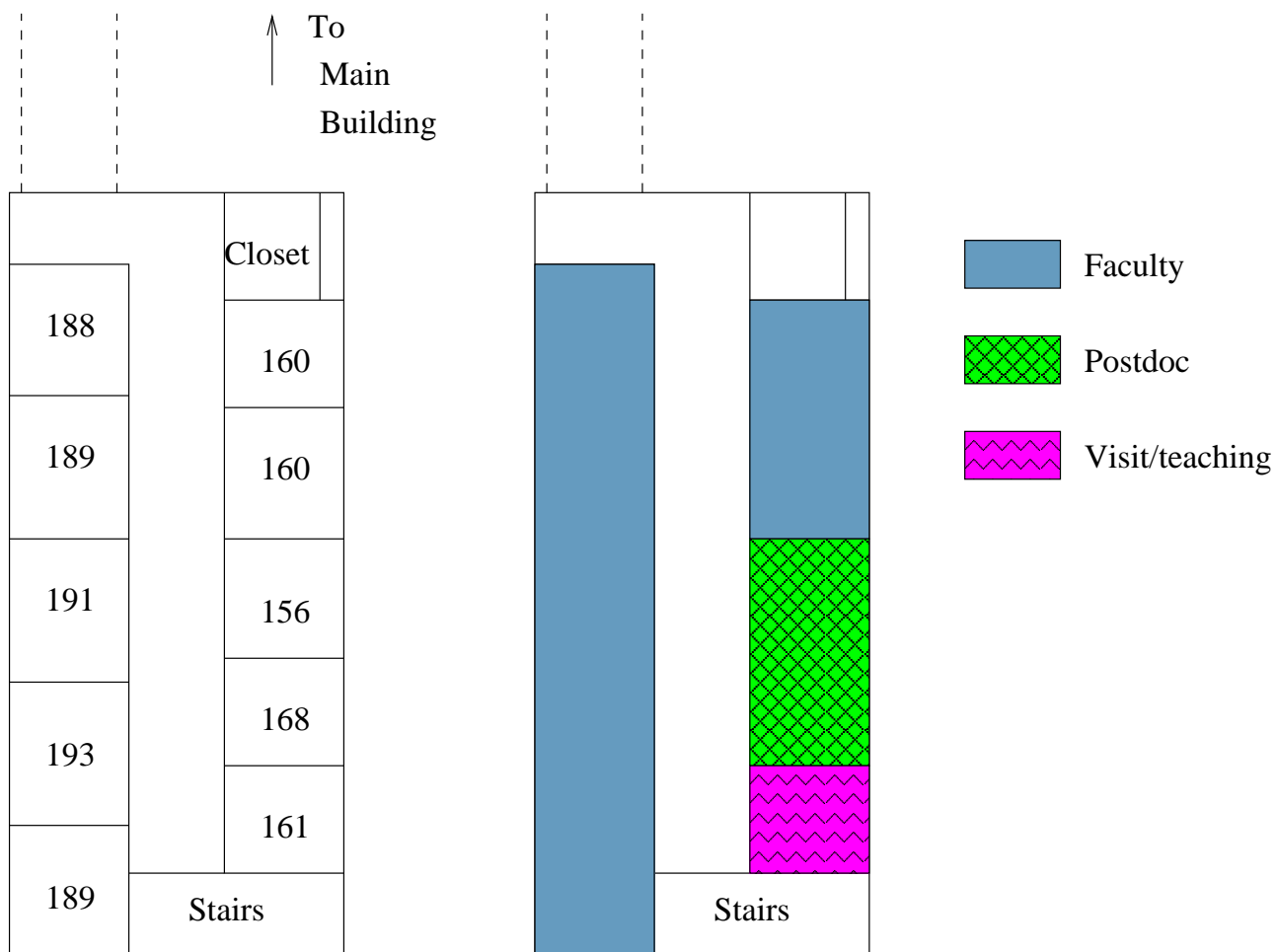



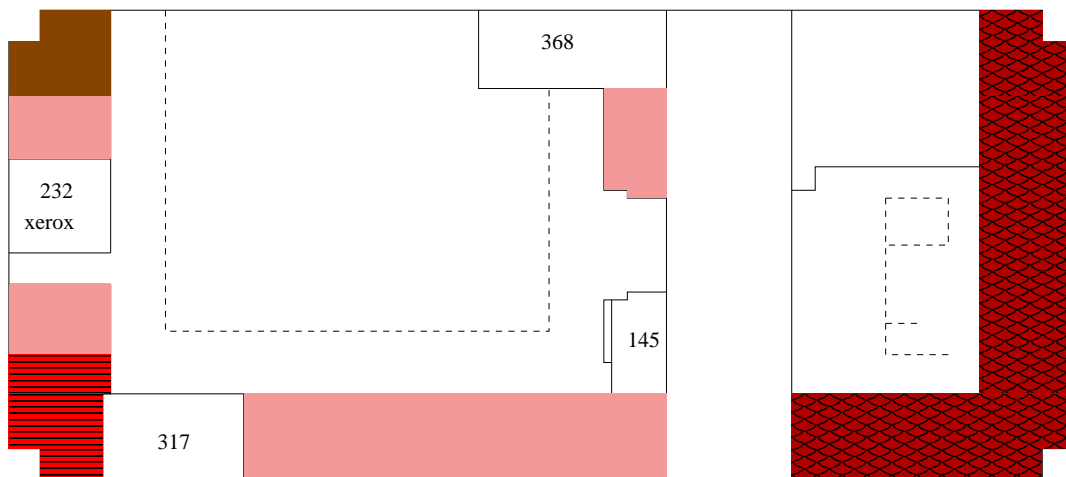
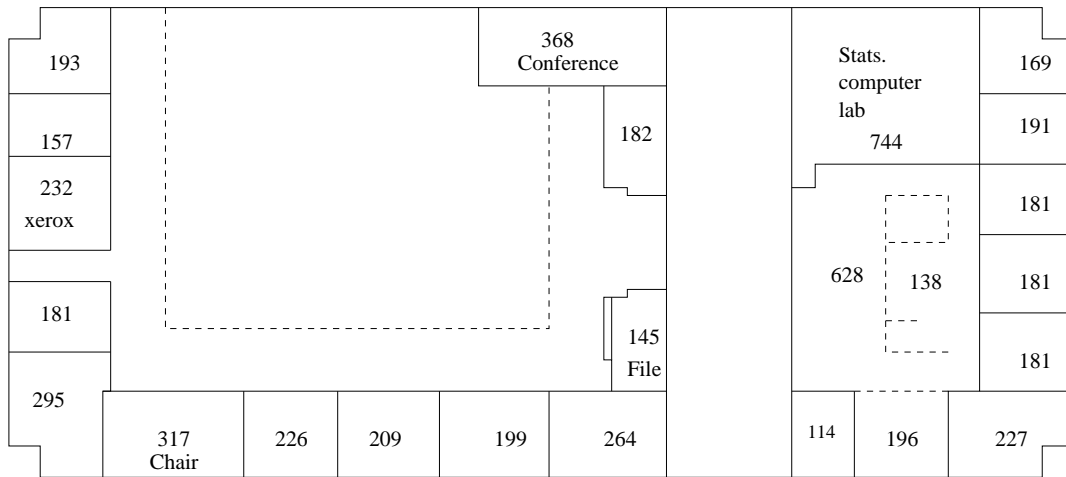





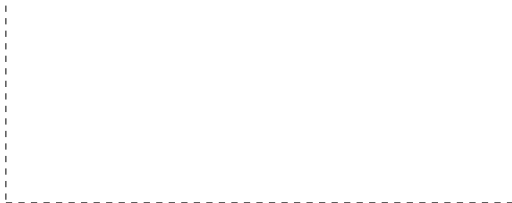

Fourth floor - Annex



- Staff office
- Stat sci office
- Lecturer
- Lounge

Third floor - Main building

531 Classroom	188		191	200		390 Classroom					181	544 Classroom	
												394 Classroom	
													382 Classroom
105		48		200								527 Classroom	
121	108				135	121	123	118	177				
	55	58											

531 Classroom		  	390 Classroom		544 Classroom	
					394 Classroom	
						382 Classroom
			   			527 Classroom

- Lecturer
- Learning skills center lect.
- Visit/teaching
- TA consulting

Second floor - Main building

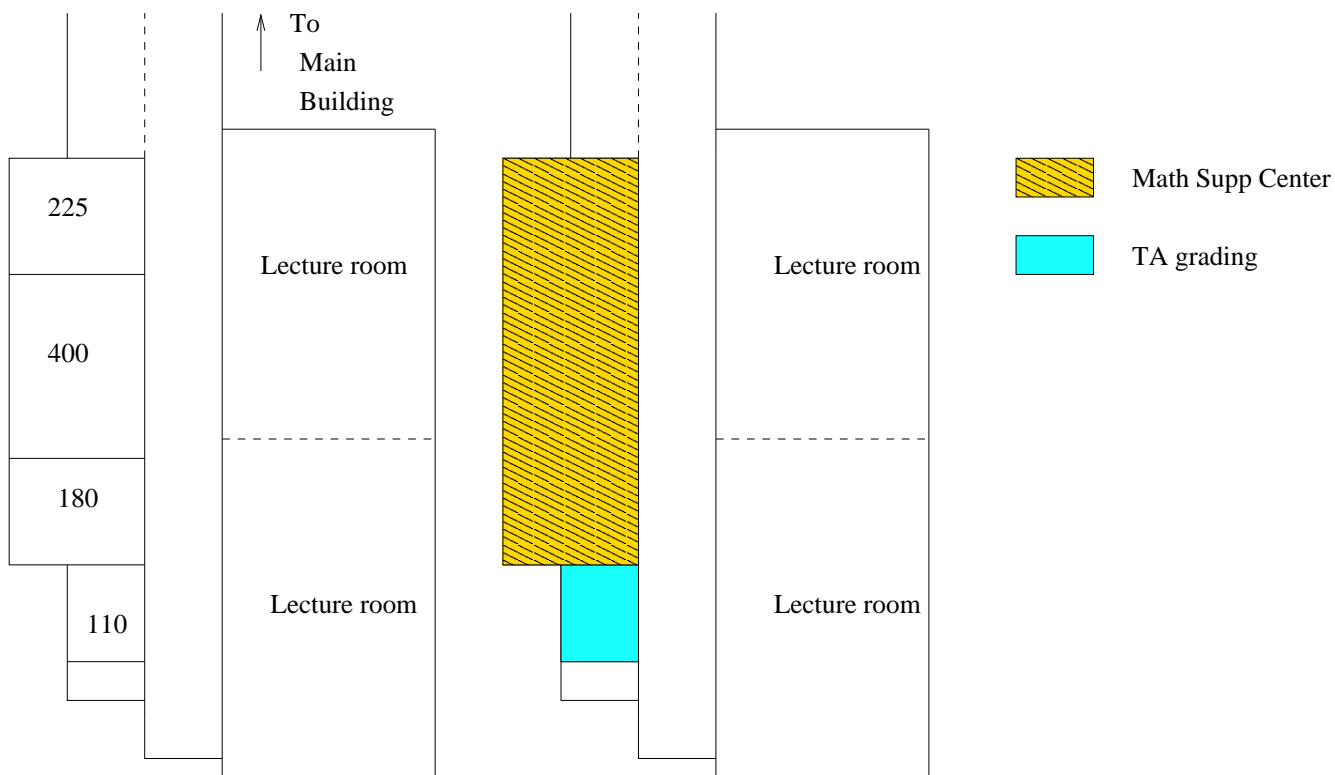

Second floor - Annex